



Fig. 0486 Delphi Carbon Canisters Features & Benefits

The spring loaded volume compensator compresses carbon to reduce internal abrasion caused by vibrations. The heavy wall, elliptically shaped body and location of the volume compensator near the end of the canister permit higher pressures (up to 5 psi) during pressure testing, thus simplifying pressure test set up.

Large surface area filters located at each end of the canister keep carbon in place and allow for the lowest airflow restrictions available.



Fig. 0486 Vapor tube

Patented "floating bracket" allows for easy installation while reducing the transmission of torque to the canister body, end caps and spuds.

The "floating bracket" also protects end caps from heat so that the factory installed heat shield is all that is needed to meet engine compartment requirements for fire protection. Builders simply install as usual with no additional effort or insulation requirements.



Activated Carbon
Volume varies depending on application

Carbon Canisters Sizing

Trailerable Boats



Non-Trailerable Boats



Use the table below to determine canister size based upon length of boat and fuel tank volume.

Trailerable Under 26 Ft

Canister (Liters)	Tank Size (Gallons)
.50	0-62
.75	63-93
1.0	94-124
1.5	125-186
2.0	187-248
3.0	249-372
4.0	373-496

Non-Trailerable Over 26 Ft

Canister (Liters)	Tank Size (Gallons)
.50	0-124
.75	125-186
1.0	187-248
1.5	249-372
2.0	373-496
3.0	497-744
4.0	745-992

1

Delphi canisters are available in sizes ranging from 0.5L to 4.0L. Each size offers hose nipple connection options of 5/16" in and 5/8" out or 5/8" in and 5/8" out. The same configurations are also available with a heat shield if required.



1.0L Shown with Optional Heat Shield

Fig. 0486



0.5L Shown with Optional Heat Shield

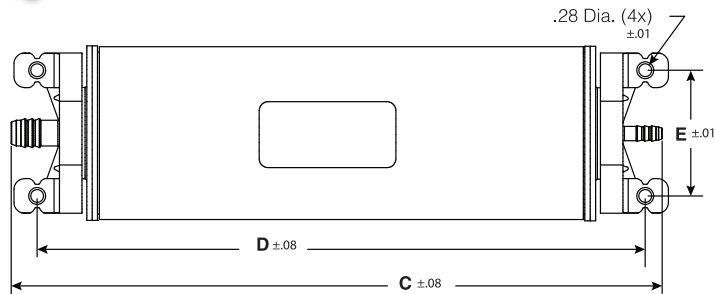
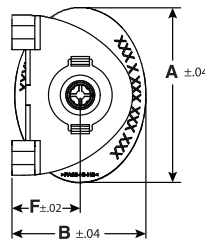

Fig 0486 - Carbon Canister Ordering & Tech Information

Catalog No.	Vent Size	Canister Size	Heat Shield	Dimensions Inches						Std. Pkg.	OEM Bulk Pkg.	Ship Wt.(lbs.) Std. Pkg./ OEM Bulk
				A	B	C	D	E	F			
0486005035	5/16" x 5/8"	0.5 Liter	No	3.83	2.90	9.65	8.72	2.76	1.50	1	10	1.5/12.5
0486005055	5/8" x 5/8"			3.83	2.90	9.85	8.72	2.76	1.50			
0486007035	5/16" x 5/8"	0.75 Liter	No	3.83	2.90	11.92	11.03	2.76	1.50	1	10	1.8/15.5
0486007055	5/8" x 5/8"			3.83	2.90	12.12	11.03	2.76	1.50			
0486010035	5/16" x 5/8"	1.0 Liter	No	3.83	2.90	14.30	13.36	2.76	1.50	1	10	2.2/18.5
0486010055	5/8" x 5/8"			3.83	2.90	14.50	13.36	2.76	1.50			
0486015035	5/16" x 5/8"	1.5 Liter	No	3.83	2.90	19.00	18.06	2.76	1.50	1	10	3.0/22.0
0486015055	5/8" x 5/8"			3.83	2.90	19.25	18.06	2.76	1.50			
0486020035	5/16" x 5/8"	2.0 Liter	No	5.03	3.78	14.74	13.80	3.57	1.89	1	5	3.2/14.5
0486020055	5/8" x 5/8"			5.03	3.78	14.94	13.80	3.57	1.89			
0486030035	5/16" x 5/8"	3.0 Liter	No	5.03	3.78	20.17	19.25	3.57	1.89	1	5	4.6/21.0
0486030055	5/8" x 5/8"			5.03	3.78	20.37	19.25	3.57	1.89			
0486040035	5/16" x 5/8"	4.0 Liter	No	5.03	3.78	25.42	24.56	3.57	1.89	1	5	5.5/26.0
0486040055	5/8" x 5/8"			5.03	3.78	25.62	24.56	3.57	1.89			
0486H05035	5/16" x 5/8"	0.5 Liter	Yes	3.83	2.90	9.65	8.72	2.76	1.50	1	10	1.6/14.0
0486H05055	5/8" x 5/8"			3.83	2.90	9.85	8.72	2.76	1.50			
0486H07035	5/16" x 5/8"	0.75 Liter	Yes	3.83	2.90	11.92	11.03	2.76	1.50	1	10	1.9/17.0
0486H07055	5/8" x 5/8"			3.83	2.90	12.12	11.03	2.76	1.50			
0486H10035	5/16" x 5/8"	1.0 Liter	Yes	3.83	2.90	14.30	13.36	2.76	1.50	1	10	2.3/21.0
0486H10055	5/8" x 5/8"			3.83	2.90	14.50	13.36	2.76	1.50			
0486H15035	5/16" x 5/8"	1.5 Liter	Yes	3.83	2.90	19.00	18.06	2.76	1.50	1	10	3.3/26.0
0486H15055	5/8" x 5/8"			3.83	2.90	19.25	18.06	2.76	1.50			
0486H20035	5/16" x 5/8"	2.0 Liter	Yes	5.03	3.78	14.74	13.80	3.57	1.89	1	5	3.6/17.0
0486H20055	5/8" x 5/8"			5.03	3.78	14.94	13.80	3.57	1.89			
0486H30035	5/16" x 5/8"	3.0 Liter	Yes	5.03	3.78	20.17	19.25	3.57	1.89	1	5	5.2/23.0
0486H30055	5/8" x 5/8"			5.03	3.78	20.37	19.25	3.57	1.89			
0486H40035	5/16" x 5/8"	4.0 Liter	Yes	5.03	3.78	25.42	24.56	3.57	1.89	1	5	6.5/30.0
0486H40055	5/8" x 5/8"			5.03	3.78	25.62	24.56	3.57	1.89			