

MOUNTING INSTRUCTIONS

These locks or latches are designed to be mounted through surfaces from 1/8* inch to 3/4 inches thick. The cam bars are adjustable to a maximum of 3 inches from the mounting surface.

- 1). Cut out the template below. Fold on dotted line. Place on mounting surface at desired location with folded tab overlapping edge.
- 2). Mark center of hole for drilling.
- 3). Drill a 2-1/2 inch hole through the mounting surface.
- 4). Insert lock or latch through the hole in the surface and attach mounting ring, tighten screws to lock body. Use #8 screws to fasten ring to underneath of mounting surface.
- 5). Attach cam bar with proper adjustment. Tighten set screw. Slide o-ring on shaft, behind the cam bar.
- 6). For locks' continued ease of operation, periodically apply a lock cylinder lubricant.

*** Note: On thinner mounting surfaces, insure enough support for mounting screws (see instruction #4).**

9/04
1094INS1

PERKO, Inc.
16490 N.W. 13th Avenue
Miami, FL 33169-5707
www.perko.com

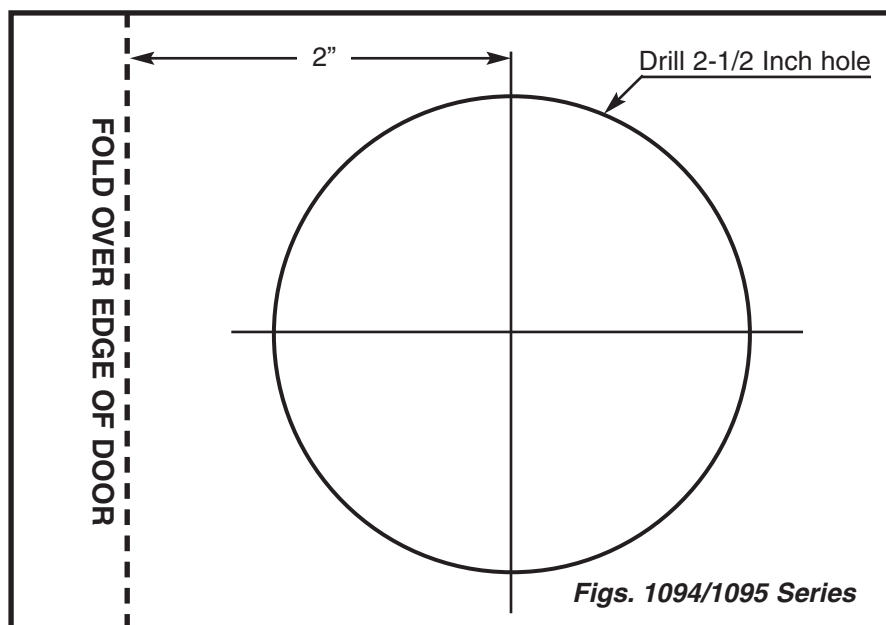
MOUNTING TEMPLATE

(SEE OVER)

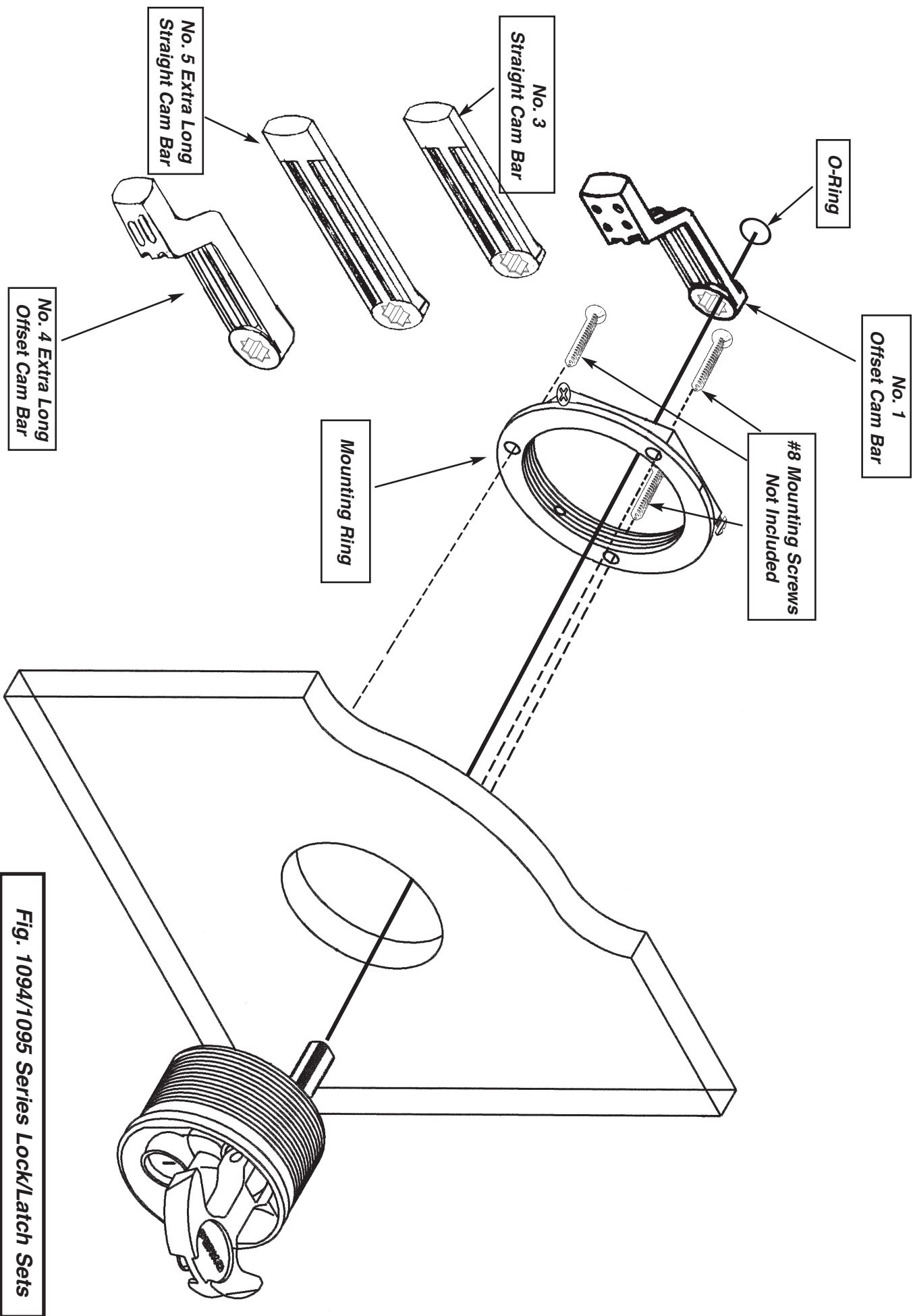

Fig. 1094/1095 Series Lock/Latch Sets